

# WATER METER CHAMBERS

## DN 600

installation of the water meter and the water fittings

### DIMENSIONS

- body height: H=1560 mm body
- diameter: 600 mm cover load:
- 15kN

### VALUES

- ribbed monolithic construction of the body ensure high rigidity and good anchoring in the ground
- closed bottom protecting the well interior from flooding in the case of high level of ground waters
- water metre console,
- placement of the water meter set in the bottom part of the well prevents freezing even in temperatures reaching -30°C
- **tight cover** (installed on the gasket)



STANDARD: AT /2007-02-2237/2



**Purpose:** installation of the water meter and water fittings at the users' connections that use the water systems.

**Body height:** H=1560 mm on request H=1800 mm

**Body diameter:** 600 mm

**Cover load:** 15kN

The installation enables fitting the DN 20 (3/4") water metre with G 1" thread and the use of inlet or outlet based on PE Ø 32 mm pipe.

Reading of the water meter on the bottom of the well is done by its temporary raising to the ground level using a handle and coiled polybutylene pipes. The well can be used in air temperature above ground up to -30°C.

Other versions of sizes, internal installations and DN 600 water metre well loads - on request. The decision on the construction on a road lane is made by a designer, road owner or future user.

During the construction and operation the product the instructions of assembly and operation must be followed.

1. Polyethylene cover with insulation
2. Chamber body
3. Water meter handle
4. Compensation screw union for DN 20 (3/4")-G1" water metre
5. Ø 32 mm polybutylene pipe
6. Polybutylene pipe handle
7. 90° 1" elbow
8. 1" Mushroom shut-off valve
- 8a. Mushroom shut-off anti-contamination valve with drainage function
9. Screwed connector for 32 mm made of PE
10. Screwed connector 45° Ø 32/1"

Water meter (ordered separately).

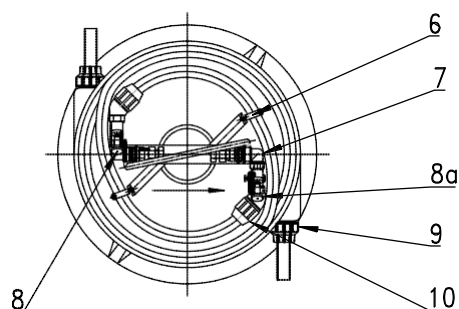
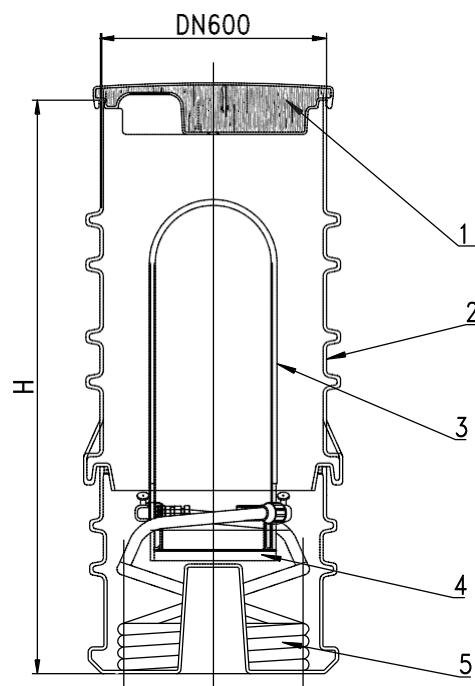

Interior of the well

## APPENDICES:

- Instruction EL-43-4/V-2011 Assembly instruction for the DN 600 polyethylene water meter well - standard version
- Technical approval AT /2007-03-2237
- Declaration of conformity no. 14
- Hygienic certificate no. HK/W/1001/01/2009
- CSW 26.11.10 price list