

WATER METER CHAMBERS

DN 600

installation of the water meter and the water fittings

DIMENSIONS

- body height: H=1600 mm
- body diameter: 600 mm
- cover load: 15kN

VALUES

- ribbed monolithic body construction for high rigidity and good ground anchorage
- closed bottom to protect the inside of the well from flooding in case of high groundwater levels
- water meter console
- placement of the water meter set in the lower part of the well prevents freezing even at outdoor temperatures down to -30°C
- leak-proof cover (gasket mounted)



Purpose: installation of water meters and water fittings at the connections of consumers using the water supply network.

Body height: H=1600 mm
on request H=1800 mm

Body diameter: 600 mm

Cover load: 15 kN

The installation enables the installation of a DN 20 (3/4") water meter with a G 1" thread and the possibility of entering and exiting it with a Ø 32 mm PE pipe.

A water meter resting on the bottom of a well is read by temporarily raising it to ground level using a handle and coiled polybutylene pipes. The well can be used at air temperatures above ground level down to -30°C.



Inside the well

Other versions of sizes, internal installations and loads of DN 600 water meter wells - on request.

The decision regarding the installation in the right-of-way is made by the designer, the owner of the road or the future user. During installation and use of the product, the instructions for assembly and operation of the well must be strictly adhered to.

1. Polyethylene cover with insulation
 2. Well body
 3. Water meter holder
 4. Compensation pipe union for water meter DN 20 (3/4")-G1"
 5. Polybutylene pipe Ø 32 mm
 6. Polybutylene pipe holder
 7. 90° elbow 1"
 8. Poppet shut-off valve 1"
 - 8a. Anti-contamination poppet shut-off valve with drain option
 9. Screwed joint Ø 32 mm in PE
 10. Screwed joint 45° Ø 32/1"
- Water meter (not included in the well equipment).

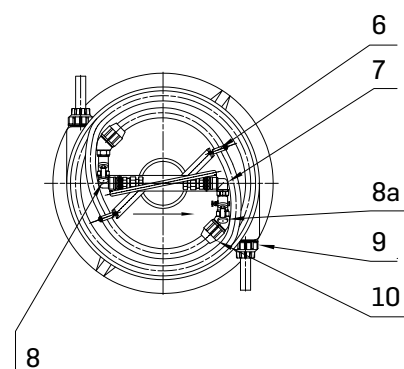
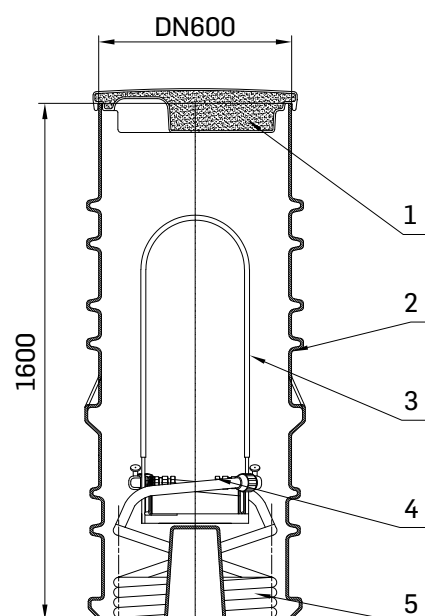

distributor