



UNIVERSAL CHAMBERS

A2 TYPE, B2 TYPE telecommunications

MATERIAL

- polyethylene

PURPOSE

- for storage and protection of small connector muffers from mechanical damages
- for fibre cable reserves for cable
- pulling in the case of arcs with small radius
- in underground installations cable wells, cellars

VALUES

- small weight - total (body + cover) for A2 and B2 type does not exceed 11 kg
- small dimensions
- perfect tightness - also in the places where pipes and cables are inserted
- easy and quick assembly
- possibility of installation in hard conditions
- easy network expansion - enables professional adaptation of one model to any duct configuration
- product durability - good mechanical strength, constructions stiffness, resistance to corrosion and chemicals
- resistance to low temperatures
- recyclable



Scan me. Full product catalogue available at www.elplastplus.pl





TECHNICAL DESCRIPTION

A2 and B2 type UNIVERSAL CHAMBERS are made of polyethylene and are a great alternative for their traditional, ex. concrete counterparts. They are mainly used in local telecommunication networks made with microducting technology. The containers are used for storage and protection of small connector muffs from mechanical damages of connection muffs, creating reserves of fibre cables and making cable junctions. They also enable pulling cables in the case of small radius

arcs. Due to small dimensions they can be used in confined spaces. They are used in underground installations, cable wells, cellars and other similar places.

The container includes a body and a cover with gasket. In the A2 type container there is a pipe that increases the acceptable pressure on the cover. In the surface assembly version the cover can have additional locks or latches, it can also be equipped with "bar" lock that makes the cover opening more difficult. Eight side flat surfaces on the body

enable inserting standard $\varnothing 32$ mm and $\varnothing 40$ mm pipes into the containers. The pipes can be inserted using: rubber gaskets, welded half-couplings, welded spigots or half-couplings with thread and nut. The assembly of rubber gaskets and half-couplings with thread can be done at the construction site.

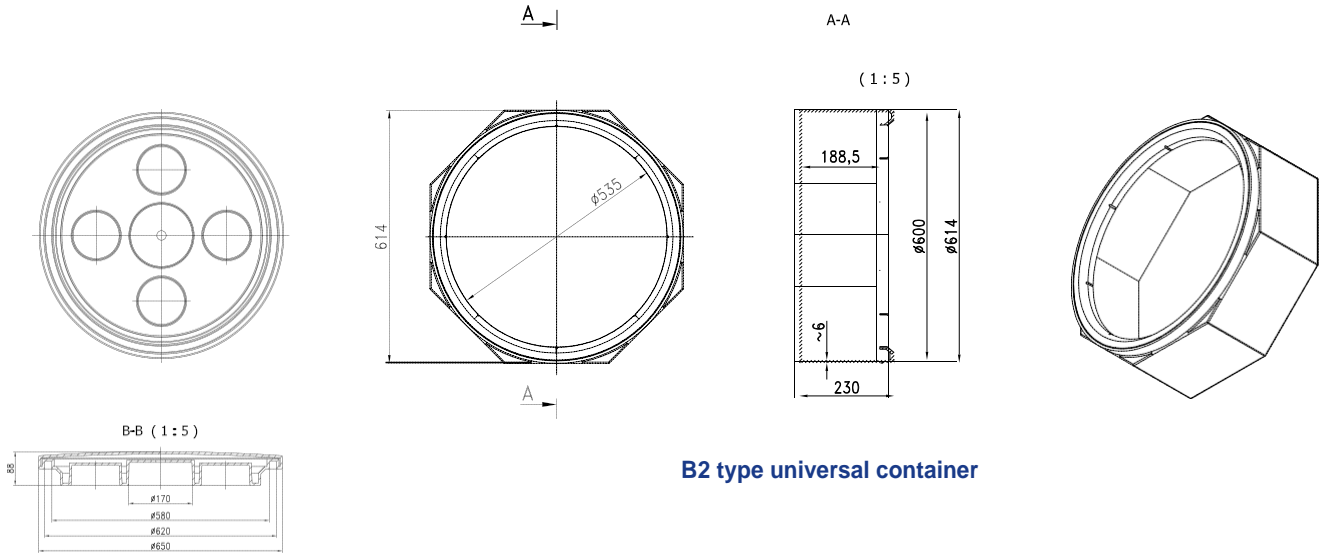

B2 type universal container

Container cover

distributor